



CREATIVE
INTERCONNECT
SOLUTIONS

EMM

MIL83513-G

PERFORMANCES

MINIATURIZED AND RUGGED

FOR HARSH ENVIRONMENT



HARSH
ENVIRONMENT

1.27mm
pitch

OUR LEITMOTIV

MAKE
YOUR
DREAMS
A REALITY
AS AN
ENGINEER
YOU CAN
MAKE
HISTORY

TOGETHER
WE'LL FIND
THE BEST
SOLUTION

WE ARE NICOMATIC

—
Creative interconnect solutions provider

SUMMARY**MAIN FEATURES**

03

OVERALL DIMENSIONS

06

A WORD FROM THE DESIGNER

07

MAIN APPLICATIONS

08

PRODUCT SPECIFICATIONS

10

PRODUCT CONFIGURATION

Straight on PCB	16
90° on PCB	17
Cabling	18
Tooling	19

INTRO

→ **DESIGNED IN 2018**

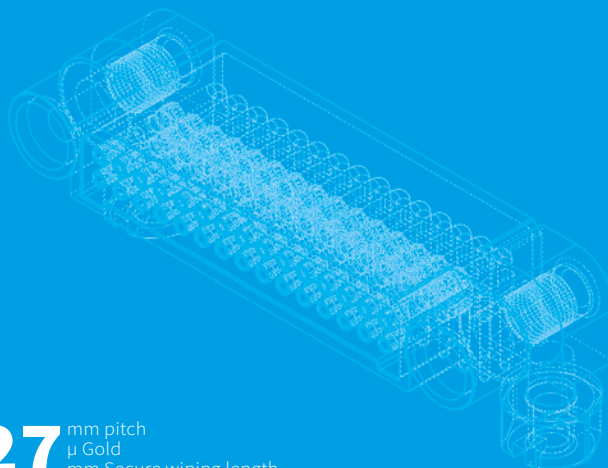

1.27 mm pitch
μ Gold
mm Secure wiping length

EMM ACHIEVES
EXTRA SPACE
AND WEIGHT
REDUCTION
TO MEET YOUR
MINIATURIZATION
NEEDS IN THE
MOST EXTREME
ENVIRONMENTS

Designed to meet the performance requirements of **MIL 83513-G**, the range combines rugged design with enhanced electrical and environmental performances

FROM THE
IDEA TO THE
FINISHED
PRODUCT

SPACE SAVING

Easy installation thanks to a perfect balance between the pitch and the overall dimensions of the range.

REVERSED CONTACTS

Male contacts, thinner by essence, are protected inside the insulator.

HIGH MODULARITY

Straight male and female thru-hole
90° male and female thru-hole
Cable AWG 24-30
04 to 60 pins.

90° BACK PROTECTION

Featured exclusively on 90° connectors mount, contacts are protected at the back by an ingenious shape, also guaranteeing a perfect alignment of the contacts.

INTERCHANGEABLE HARDWARE

Locking and guiding functions available, adaptable on both male and female connectors

MATERIALS

Moulding: High performance glass fiber composite (LCP)
Male pins: Copper alloy, Au 0.75μ
Female pins with tulip technology (clip with 4 finger spring contact)
Outer: Copper alloy, Au 0.125μ
Inner: Beryllium copper, Au 1.27μ

FUTURE IS SMALLER ■

SPACE & WEIGHT SAVING



RESPONSIVENESS IS KEY ■

MODULAR & RUGGED

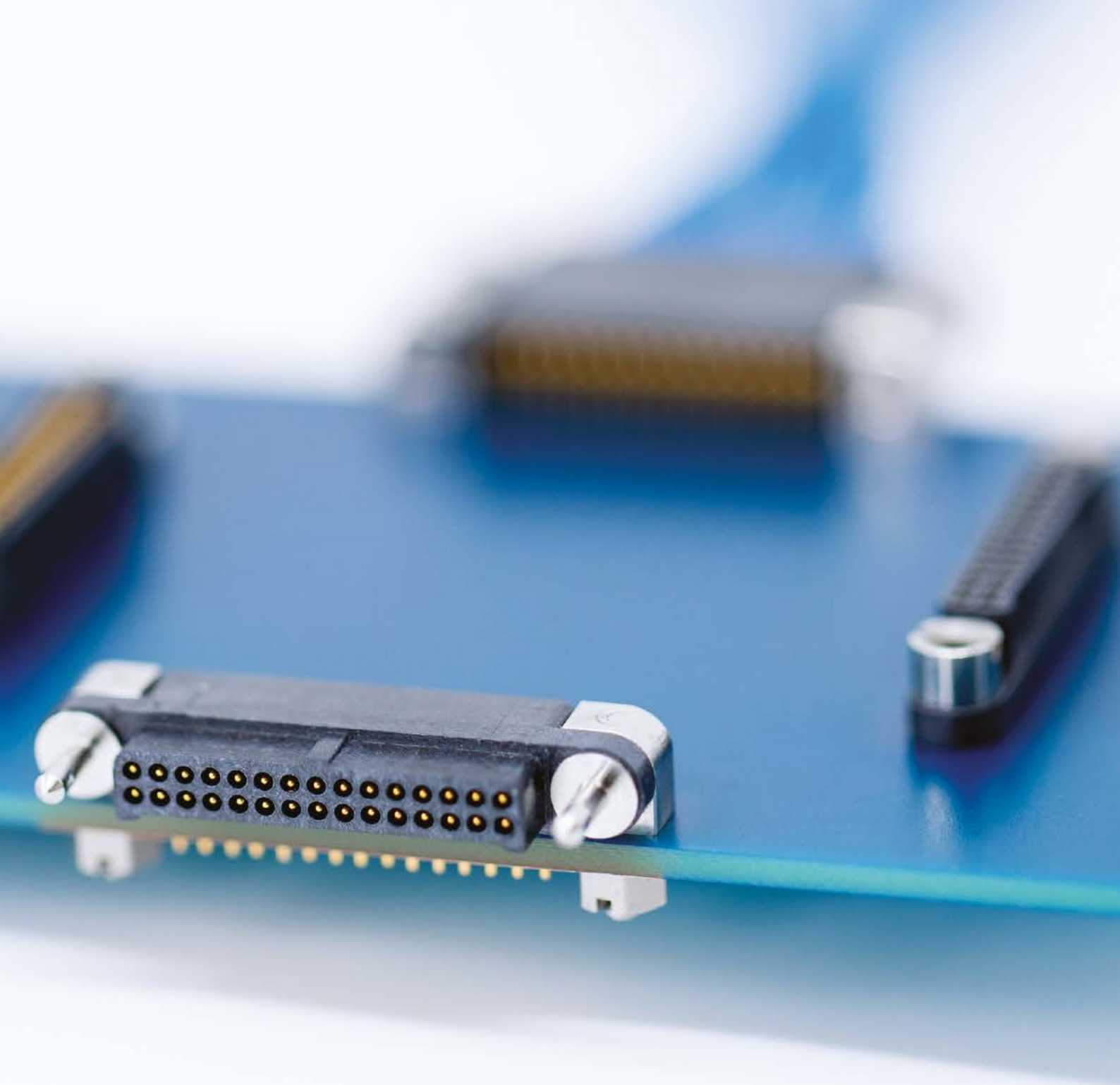

EMM / Overall dimensions

MALE AND FEMALE
STRAIGHT ON PCB

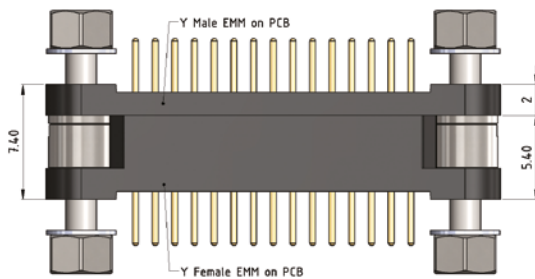

MALE 90° AND FEMALE
STRAIGHT ON PCB

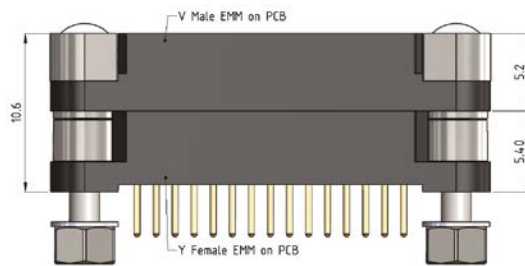

MALE STRAIGHT AND FEMALE
90° ON PCB

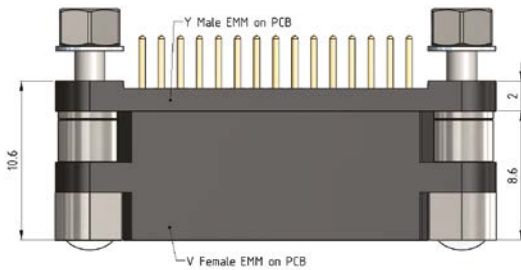

MALE AND FEMALE
90° ON PCB

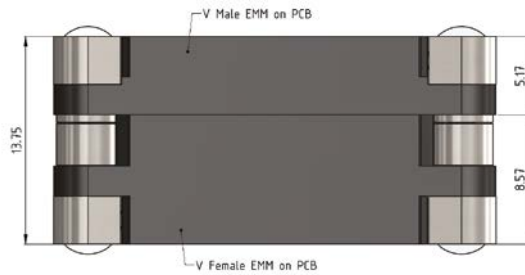

MALE ON CABLE AND FEMALE
STRAIGHT ON PCB

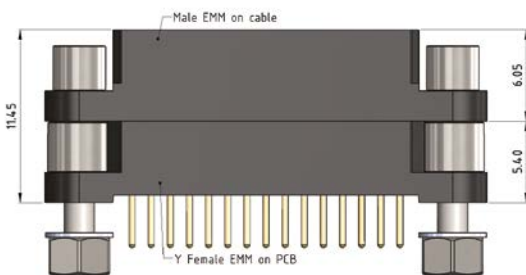

MALE ON CABLE AND FEMALE
90° ON PCB

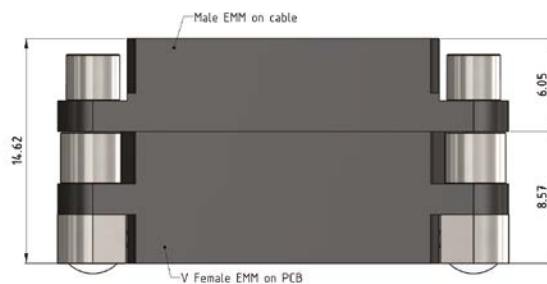

→ MARKING AND POLARIZATION

EXAMPLE
AA (Year):2018
SS (Week):09
. Pin nbr 1

MARKING

NCM = NicomaticTH brand
AASS = year + week batch

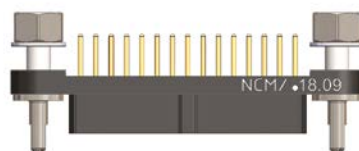

A FEW WORDS

Jérôme
Designer
& Project manager

“This project is a model of collective success. All Nicomatic departments have been involved and brought their own touch of innovation to the global EMM product offer. Focusing on simplicity and efficiency my main objective was to limit the mechanical stress. As a result the EMM connector meets the global constraints of our customers, from both a functional and a service perspective. What we experienced and learned during the development of the EMM will benefit our other connector ranges too. EMM already offers a great modularity, and it is just the beginning !”

EMM / Main applications

Proven technology / Harsh environment requirements



→ DEFENCE

Note: Our products help to make easier maintenance



High vibration



Space saving



Modularity

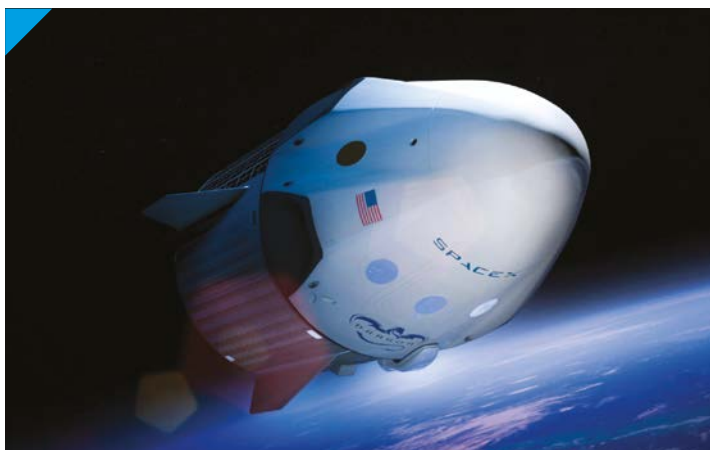

→ SPACE

Note: There is no wayback for your projects



Weight saving



High altitude

TMC

Outgassing



→ MOTOR SPORT

Note: Secure your equipment



Reliability



Shock resistance



High vibration



→ CIVIL AVIATION

Note: Data reliability is a matter of life



Weight saving



Modularity



Space saving



→ UAV

Note: Saving weight and space



Weight saving



Space saving



Modularity



→ ROBOTICS

Note: High modularity



Shock resistance



Space saving



Modularity

NEED
A MINIATURIZED
& RUGGED
CONNECTOR ?

EMM
IS YOUR
SOLUTION

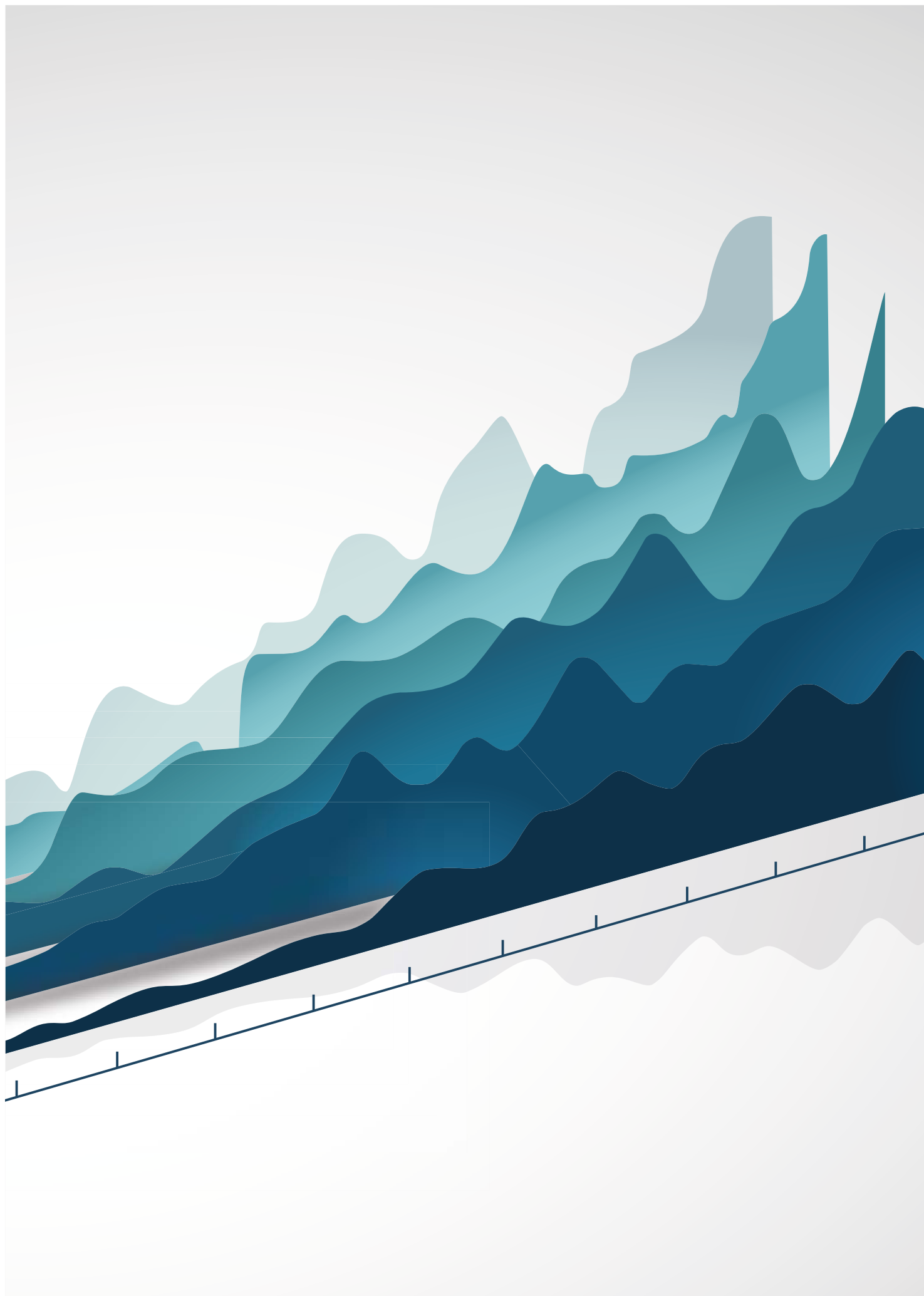

DEBIT
(DB)

8

7

6

5

4

3

2

1

ACTIONS
SPEAK
LOUDER
THAN WORDS

Consult test reports
in free access on our website !
→ services / lab reports

HIGHEST
REQUIREMENTS

PRODUCT SPECS

CHALLENGE YOUR LIMITS

MEET OR EXCEED

MIL-DTL-83513G
PERFORMANCE

**ALL OUR
ENGINEERS
SUPPORT YOU**

We bring you concrete tips.



Features	EMM Results
Electrical performance requirements	
Dielectric Withstanding Voltage sea level EIA-364-20C <i>(Between all adjacent contacts & fixings)</i> Dielectric withstanding voltage @sea level: 600 V RMS. Connectors shall show no evidence of breakdown or flashover	Dielectric withstanding voltage: 750 V RMS Breakdown voltage: 1000 V RMS Rated voltage: 250 V RMS
Dielectric withstanding voltage high altitude EIA-364-20C <i>(Between all adjacent contacts & fixings)</i> Dielectric withstanding voltage @70 000 ft: 150V RMS. Connectors shall show no evidence of breakdown or flashover	Dielectric withstanding voltage @30 000 ft: 540 V RMS Dielectric withstanding voltage @70 000 ft: 480 V RMS
Insulation Resistance EIA 364-21C Shall not be less than 5 GΩ after temperature cycling and humidity	> 2000 GΩ@ 500V
Contact Resistance EIA 364-06C For AWG 24, contact resistance shall be less than 24 mΩ	Less than 8 mΩ
Low level contact resistance EIA 364-06C For AWG 24, shall be less than 25 mΩ	Less than 9 mΩ
Magnetic permeability ASTM A342/A342M Shall not exceed 2 gamma	Less than 2 gamma
Contact Current Capability (derating) IEC 60512-5-2 Test 5b For PCB connectors, contacts shall be capable of carrying 3.0 A in continuous duty operation from -55°C to 150°C For contacts on cable, derating is depending on the cable. Refer to test results	3A@25°C and 1.6A@85°C for 30 pins
Mechanical features	
Contact engagement and separation forces EIA 364-37B For AWG24, contact engaging shall not exceed 1,67 N and contact separation shall be 0.14N min	Engagement force: 1N max Separation force: 0.15 N
Connector mating and unmating forces EIA 364-13D Shall not exceed a value equal to 2,78 N times the number of contacts	Values for configurations up to 30 pins Mating Force: 1.7N max Unmating Force: 0.1N min
Durability MIL-DTL-83513G \$4,5,16 Counterpart connectors shall show no mechanical or electrical defects detrimental to the operation of the connector after 500 cycles of mating and unmating	Values for configurations up to 30 pins Qualified
Crimp tensile strength EIA 364-08B IPC-WHMA-A-620B Requested: AWG24 > 35.6 N / AWG26 > 22.3 N / AWG28 > 13.4 N AWG30 > 6.7 N NASA-STD 8739.4 Requested AWG24>22.3N / AWG 26>13.5N	AWG 24: 49.98 N min AWG 26: 36.64 N min AWG 28: 16.90 N min AWG 30: 11.30 N min

Features	EMM Results
Environmental features	
Vibration <i>EIA 364-28E TEST CONDITION III&IV</i> Shall be no interruption of electrical continuity or current flow longer than 1 microsecond <i>MIL-DTL-83513G Test Condition IV: [196.1 m/s² (20 gn) peak] 10 to 2000 Hz_20 min/cycle_12 cycles/axe (3 axes)</i>	<i>Values for configurations up to 30 pins</i> Up to 45g
Shock <i>EIA 364-27B TEST CONDITION G</i> Shock severity: MIL-DTL-83513G Test Condition G Peak acceleration: 100 g / Normal Duration: 6 ms / Waveform: Saw tooth	<i>Values for configurations up to 30 pins</i> Up to 160g
Temperature cycling <i>EIA 364-32D</i> Temperature cycling severity: -55°C + 125°C	Temperature cycling severity: -65°C +260°C
Fluid immersion <i>MIL-DTL-83513G §4,5,18</i> A. Lubricating oil Aircraft turbine engines, synthetic base: 20 hours B. Coolant-dielectric fluid synthetic silicate ester base lubricant (coolanol 25): 1 hour +/- 1 minute	Qualified
Humidity <i>EIA 364-31B - Method IV</i> Ten cycles 25°-65°C, 95%RH, cycle duration: 24 hours (except steps 7a and 7b) Withstanding voltage sea level after Humidity: 360 V RMS Insulation resistance after Humidity: >1 GΩ	Qualified
Salt spray (corrosion) <i>364-26B TEST CONDITION A</i> Duration: 96 hours @35°C / Salt solution concentration: 5%	<i>Values for configurations up to 30 pins</i> Qualified
Thermal vacuum outgassing <i>ASTM E595 (ECSS-Q-ST-70-02C)</i> Total mass loss: TML < 1% of the original mass Max volatile condensable material: CVCM < 0.1% of the original mass Applicable to LCP housing, ring in peek (AWG24 cabling) and backpotting Stycast 2651 MM+catalyst 9	Qualified PEEK (TML 0.18 %, CVCM 0.01 %) / LCP (TML 0.06 %, CVCM 0.01%) / STYCAST 2651 (TML 0.43 %, CVCM 0.01%)
Resistance to soldering heat <i>EIA 364-29C</i> MIL STD 202 method 210F Bath solder T°: 260°C - 10 s Iron: 350°C - 5 s	<i>Values for configurations up to 30 pins</i> Qualified
Marking <i>MIL-STD-202, method 215</i> Solvent 1: Isopropyl alcohol, Kerosene (Petroleum ether), Ethylbenzene. Solvent 3: Ethanolamine, 1-methoxy-2- propanol, Water. Solvent 4: Propylene glycol, Monoethanolamine	Qualified
Fungus Resistance 28 days/29°C/HR 90%/ TCA DO 160G	Qualified grade 0 or 1



EMM
RANGE

CONFIGURE YOUR SOLUTION

BUILD YOUR PART NUMBER

**ALL OUR
ENGINEERS
SUPPORT YOU**

We bring you concrete tips.



EMM





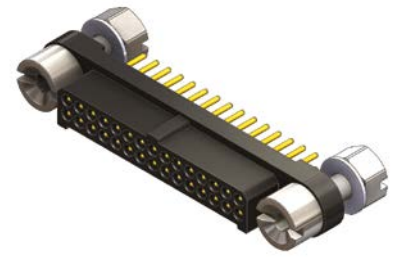

Thru hole terminations
PCB from 0.8 to 2mm

Straight on PCB



Racking or locked fixing hardware

EMM connectors perfectly meet the needs of PCB to PCB configurations: the guiding function of their fixing hardware ease the installation process, while their great wiping length (1.27 mm min) ensures secure mating in the most severe conditions.

Part numbering							
E Series 2 rows	Gender	LF contact type	LF contact nbr	Fixing	Visual	Mating	Visual
E22	1 Male	Y Straight Thru hole 3mm	04 to 60	E10 Male Straight Guiding		E60/E61	
	2 Female			E50 Female Straight Jackscrew		E01	
				E60 Female Straight Guiding		E10/E11	

→ FIXING HARDWARE

All the fixing hardware is compatible with male and female connectors

Code	Description	PCB thickness (mm)	Torque (Nm)	Overview
E10	Male Straight Guiding	0.8 to 2 max	0.3	
E50	Female Straight Jackscrew	0.8 to 2 max	0.3	
E60	Female Straight Guiding	0.8 to 2 max	0.3	

→ THRU HOLE TYPE PCB LAYOUT

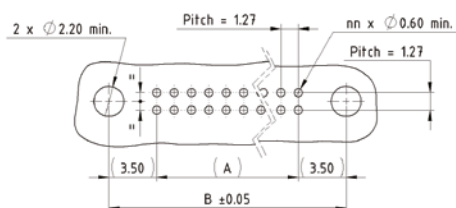

Dimension table																															
LF contact number	4	6	8	10	12	14	16	18	20	22	24	26	28	30	32	34	36	38	40	42	44	46	48	50	52	54	56	58	60		
A=Distance between pins (mm)	1.27	2.54	3.81	5.08	6.35	7.62	8.89	10.16	11.43	12.70	13.97	15.24	16.51	17.78	19.05	20.32	21.59	22.86	24.13	25.40	26.67	27.94	29.21	30.48	31.75	33.02	34.29	35.56	36.83		
B=Distance between fixings	8.27	9.54	10.81	12.08	13.35	14.62	15.89	17.16	18.43	19.7	20.97	22.24	23.51	24.78	26.05	27.32	28.59	29.86	31.13	32.4	33.67	34.94	36.21	37.48	38.75	40.02	41.29	42.56	43.83		

EMM







Thru hole terminations
PCB from 0.8 to 2mm

90° on PCB



Racking or locked fixing hardware

EMM 90° on PCB connectors present an exclusive feature to reinforce robustness. The back shape of the connector brings additional protection and ensures a perfect alignment of the contacts.

Part numbering							
E Series 2 rows	Gender	LF contact type	LF contact nbr	Fixing	Visual	Mating	Visual
E22	1 Male	V 90° Thru hole 3mm	04 to 60	E11 Male 90° Guiding		E60/E61	
	2 Female			E51 Female 90° Jackscrew		E01	
				E61 Female 90° Guiding		E10/E11	

→ FIXING HARDWARE

All the fixing hardware is compatible with male and female connectors

Code	Description	PCB thickness (mm)	Torque (Nm)	Overview
E11	Male 90° Guiding	0.8 to 2 max	0.3	
E51	Female 90° Jackscrew	0.8 to 2 max	0.3	
E61	Female 90° Guiding	0.8 to 2 max	0.3	

→ THRU HOLE TYPE PCB LAYOUT

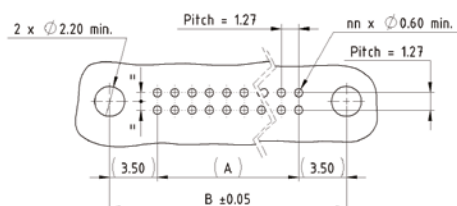

Dimension table																															
LF contact number	4	6	8	10	12	14	16	18	20	22	24	26	28	30	32	34	36	38	40	42	44	46	48	50	52	54	56	58	60		
A=Distance between pins (mm)	1.27	2.54	3.81	5.08	6.35	7.62	8.89	10.16	11.43	12.70	13.97	15.24	16.51	17.78	19.05	20.32	21.59	22.86	24.13	25.40	26.67	27.94	29.21	30.48	31.75	33.02	34.29	35.56	36.83		
B=Distance between fixings (mm)	8.27	9.54	10.81	12.08	13.35	14.62	15.89	17.16	18.43	19.70	20.97	22.24	23.51	24.78	26.05	27.32	28.59	29.86	31.13	32.40	33.67	34.94	36.21	37.48	38.75	40.02	41.29	42.56	43.83		

EMM

Pre wired or to crimp contacts
With backpotting



For cabling



Locked fixing hardware

**To crimp or pre cabled, from AWG24 to AWG30 :
whatever your expectation, EMM connectors
will meet your need. Backpotting is recommended
for enhanced protection.**





→ TO CRIMP

Part numbering							
E Series 2 rows	Gender	LF contact type	LF contact nbr	Fixing	Visual	Mating	Visual
E22	1 Male	A AWG 24 Contact Ø0.66 mm with ring in Peek	04 to 60	E01 Jackscrew for Harness		E50/E51	E50 
		B AWG 26 Contact Ø0.66 mm					E51 
		G AWG 28-30 Contact Ø0.46 mm					

Contacts A and B are the same ones. The differentiation in the codification comes from the addition of a ring in peek to crimp the AWG 24.

Code	Description	Torque (Nm)	Overview
E01	Jackscrew for harness	0.2	

→ SIGNAL CONTACT

Code	Reference	Type	Cable gauge	Current carrying capacity @25°C	Derating @25°C	Recommended wire	View
A	18224 + 18281	To be crimped	AWG 24	Up to 5A	Up to 4A	M16878/6-BEE	
B	18224		AWG 26	Up to 4.5A	Up to 3.5A	M16878/6-BDE	
G	18240		AWG 28	Up to 4A	Up to 3.2A	M16878/6-BCE	
	18240		AWG 30	Up to 3.2A	Up to 2.6A	M16878/6-BBE	

Values for configurations up to 30 pins

→ PRE CABLED

Part numbering									
E Series 2 rows	Gender	Signal wire + color #	Shape & potting	LF contact nbr	Fixing	Serie HP / HF Contact	Shielding	Config.	Length
HE22	1 Male	D# AWG 30	P 2mm potting shape	04 to 60	E00 no fixing	Ø If signal (LF) contacts only	Z no	F Fly lead	XXXX
		H# AWG 28						N Back to back reversed	
		I# AWG 26	Q 2mm potting shape + potting		E01 Jackscrew for Harness			N Back to back reversed	
		J# AWG 24							

TOOLING

→ SIGNAL(LF) CONTACT
CRIMPING TOOL

Reference	Description	View
MH800	Crimping Hand tool DANIELS MH800	
C19040	Positioner for signal contacts	

# WIRE COLOR	
0	Black
1	Brown
2	Red
3	Orange
4	Yellow
5	Green
6	Blue
7	Violet
8	Grey
9	White
R	Rainbow repeated



Crimping instruction available on the website ICLF02

→ SIGNAL(LF) CONTACT
INSERTION/EXTRACTION TOOL

Reference	Description	View
C19039	Insertion&Extraction tool	



Instruction available on the website IILF02

CREATIVE INTERCONNECT SOLUTIONS

With over 40 years of experience, Nicomatic combines a proven track record and continuous innovation.

We provide solutions for defense, security, energy, space, civil avionics, and many other applications, respecting our core values based on service, quality and close relationship with our customers.

HUMAN FACTOR

is the key to success.

*We promote initiative and responsibility,
We encourage creativity & reactivity,
To better meet your needs and anticipate your requirements.*

Ready to join our team ?

recruitment@nicomatic.com

HEADQUARTER

FRANCE

T: +33 (0)4 50 36 13 85
france@nicomatic.com

MEMBER OF
Gifas - Eden
Aerospace cluster

SUBSIDIARIES

UNITED STATES

T: +1 215 444 9580
usa@nicomatic.com

CHINA

T: +86 (0)22-23858836
china@nicomatic.com

INDIA

T: +91 80 4213 1574
india@nicomatic.com

UNITED KINGDOM

T: + 44 (0)11 83 801033
uk@nicomatic.com

GERMANY

T: +49 (0) 171 305 49 80
germany@nicomatic.com

TURKEY

T: +90 (0) 312 504 37 29
turkey@nicomatic.com

SOUTH KOREA

T: +82 (0)2 553 6822
korea@nicomatic.com

JAPAN

T: +81 (0)80 2138 0909
japan@nicomatic.com

SINGAPORE

T: +65 6262 1280
singapore@nicomatic.com

TAIWAN

T: +886 (0)2 2311 2667
mailto:taiwan@nicomatic.com

CANADA

T: +41 (0) 438 885 3395
canada@nicomatic.com



WEBSITE
nicomatic.com